



DIESEL RECEIVERS STEEL & ALUMINIUM



Mining | Quarry | Construction



"FLUID EQUIPMENT SPECIALISTS"

WWW.SILVERIENG.COM | SALES@SILVERIENG.COM | 1300 716 413 | WHATSAPP +61 458 047 075

FF2026-15



DIESEL RECEIVERS STEEL & ALUMINIUM



DIESEL STEEL RECEIVERS R150S

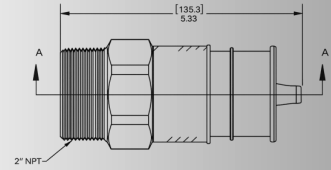

The R150S Standard Diesel Fuel Receiver is manufactured from solid steel and nickel-plated to provide maximum durability and extended service life in harsh operating environments. Engineered for high-performance refuelling applications, the R150S is capable of accommodating flow rates up to 800 LPM (211 GPM), making it ideal for mining, construction, rail, forestry, and heavy industrial equipment.

Fast Fill Systems fuel receivers are fully compatible with all major manufacturers' diesel fuel nozzles, allowing easy integration into existing fast refuelling systems. Designed for reliable, clean, and efficient fuel transfer, the R150S helps minimise downtime, reduce fuel contamination, and improve operator safety during refuelling operations.

Available shut-off pressure options include: 7 PSI, 9 PSI, 11 PSI, 12 PSI



DIESEL RECEIVER OPTIONS - STEEL		
WITHOUT CAP	WITH CAP	DESCRIPTION
R150S-A	R150SC-A	FUEL RECEIVER (9 PSIG SHUT-OFF PRESSURE, BLACK POPPET) - STEEL
R150S-B	R150SC-B	FUEL RECEIVER (11 PSIG SHUT-OFF PRESSURE, BLUE POPPET) - STEEL
R150S-D	R150SC-D	FUEL RECEIVER (7 PSIG SHUT-OFF PRESSURE, RED POPPET) - STEEL
R150S-E	R150SC-E	STEEL FUEL RECEIVER WITH PURPLE POP USE W/PRESSURIZED W/HIGH HEAD PRESSURE
R150S-J	R150SC-J	FUEL VALVE RECEIVER (12 PSIG SHUT-OFF PRESSURE, GREEN POPPET) - STEEL



DIESEL ALUMINIUM RECEIVERS R150A

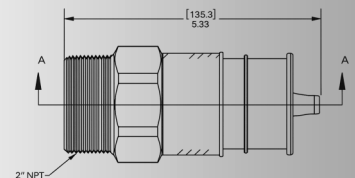

The R150A Standard Diesel Fuel Receiver is a high-performance aluminium receiver engineered for fast, reliable, and safe diesel refuelling across mining, construction, transport, rail, and heavy industrial applications. Manufactured from high-grade aluminium and precision machined for durability, the R150A provides excellent corrosion resistance while offering a lightweight alternative to traditional steel receivers.

Designed to support high-flow diesel transfer applications, the R150A accommodates flow rates up to 800 LPM (211 GPM) and is fully compatible with all major manufacturers' diesel fuel nozzles. Its robust construction and precision sealing surfaces ensure dependable operation in the harshest environments.

Available shut-off pressure options include: 7 PSI, 9 PSI, 11 PSI

DIESEL RECEIVER OPTIONS - ALUMINIUM		
WITHOUT CAP	WITH CAP	DESCRIPTION
R150A-A	R150AC-A	FUEL RECEIVER (9 PSIG SHUT-OFF PRESSURE, BLACK POPPET) ALUMINIUM
R150A-B	R150AC-B	FUEL RECEIVER (11 PSIG SHUT-OFF PRESSURE, BLUE POPPET) ALUMINIUM
R150A-D	R150AC-D	FUEL RECEIVER (7 PSIG SHUT-OFF PRESSURE, RED POPPET) ALUMINIUM